

# Floor Plan

Client	Betsy Dotterer			
Property Address	4003 Hanover Ave			
City	Richmond	County	City of Richmond	State VA Zip Code 23221
Owner	Chan Sau & Blackstone Carey Jr			

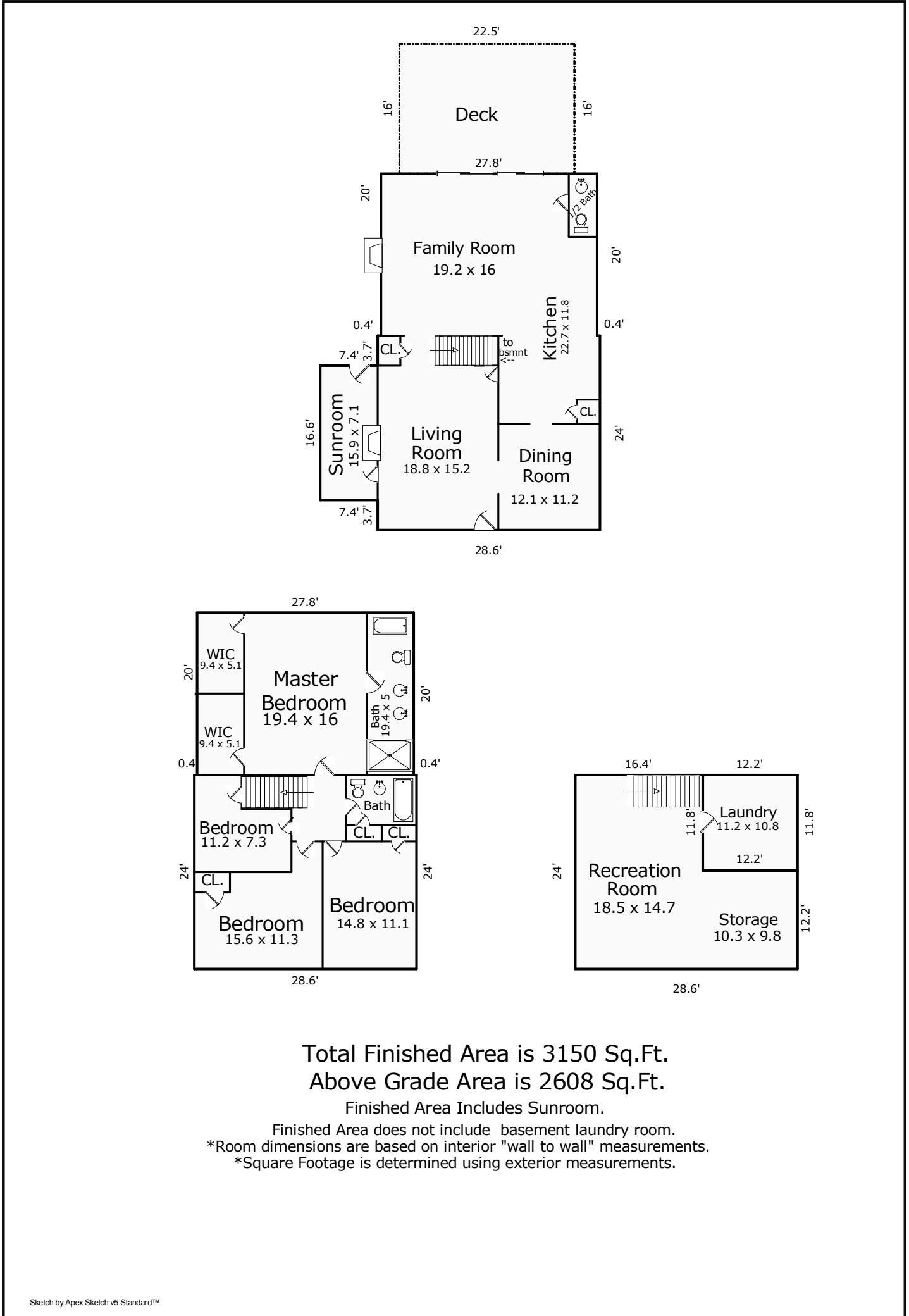

**Total Finished Area is 3150 Sq.Ft.**

**Above Grade Area is 2608 Sq.Ft.**

Finished Area Includes Sunroom.

Finished Area does not include basement laundry room.

\*Room dimensions are based on interior "wall to wall" measurements.

\*Square Footage is determined using exterior measurements.

Sketch by Apex Sketch v5 Standard™

## Calculations

Client	Betsy Dotterer				
Property Address	4003 Hanover Ave				
City	Richmond	County	City of Richmond	State	VA
Owner	Chan Sau & Blackstone Carey Jr				
				Zip Code	23221

AREA CALCULATIONS SUMMARY			
Code	Description	Net Size	Net Totals
GLA1	First Floor	1365.24	1365.24
GLA2	Second Floor	1242.40	1242.40
BSMT	Finished Basement	542.44	
	Partially Finished	143.96	686.40
P/P	Wood Deck	360.00	360.00
Net LIVABLE Area		(rounded)	2608

LIVING AREA BREAKDOWN			
Breakdown			Subtotals
<b>First Floor</b>			
28.6	x	3.7	105.82
20.0	x	27.8	556.00
3.7	x	28.6	105.82
16.6	x	36.0	597.60
<b>Second Floor</b>			
28.6	x	24.0	686.40
20.0	x	27.8	556.00
6 Items		(rounded)	2608

First Floor	GLA1
28.6	3.7
x	=
105.82	
20.0	27.8
x	=
556.00	
3.7	28.6
x	=
105.82	
16.6	36.0
x	=
597.60	

Second Floor	GLA2
28.6	24.0
x	=
686.40	
20.0	27.8
x	=
556.00	

Area total (rounded) = 1365

Area total (rounded) = 1242

Finished Basement	BSMT
11.8	16.4
x	=
193.52	
12.2	28.6
x	=
348.92	

Partially Finished	BSMT
11.8	12.2
x	=
143.96	

Area total (rounded) = 542

Area total (rounded) = 144

Wood Deck	P/P
16.0	22.5
x	=
360.00	

Area total (rounded) = 360